



## Department of Public Works

- Flood Control
- Operations
- Solid Waste Management
- Surveyor
- Transportation

Kevin Blakeslee, P.E.  
Director

# PROJECT FACT SHEET

**DATE:** August 13, 2019

**PROJECT LOCATION:** Park Boulevard, from Alta Loma Drive to State Highway 62 in the Joshua Tree area, as shown on the attached location map.

**PROJECT DESCRIPTION:** Construction will include pulverizing the existing asphalt surface and paving with new asphalt concrete, placing new AC dikes, painting traffic stripes, and other related improvements.

**DETOUR INFORMATION:** Park Boulevard is currently planned to remain open to one-way traffic with flaggers between the hours of 7:00 AM and 5:00 PM while work is under way, and will be open to two-way traffic between the hours of 5:00 PM and 7:00 AM.

The roadway will be narrow and unpaved for the majority of construction duration, and various side streets connecting to Park Boulevard may be closed to thru traffic at various times.

**ANTICIPATED CONSTRUCTION DATE:** September 3, 2019 – October 28, 2019

**COUNTYWIDE VISION:** This project was approved by our Board of Supervisors upon the passing of the County's 2019-2020 budget. This project is in line with the Countywide Vision of a sustainable system of public safety. In its dedication to the Vision, the Department is continuing its ongoing efforts of constructing improvements on County maintained roads.

**CONTACT:** Larry White, P.E., Resident Engineer  
(909) 387-7924 – [lwhite@dpw.sbcounty.gov](mailto:lwhite@dpw.sbcounty.gov)

## BOARD OF SUPERVISORS

ROBERT A. LOVINGOOD  
First District

JANICE RUTHERFORD  
Second District

DAWN ROWE  
Third District

CURT HAGMAN  
Chairman, Fourth District

JOSIE GONZALES  
Vice Chair, Fifth District

Gary McBride  
Chief Executive Officer

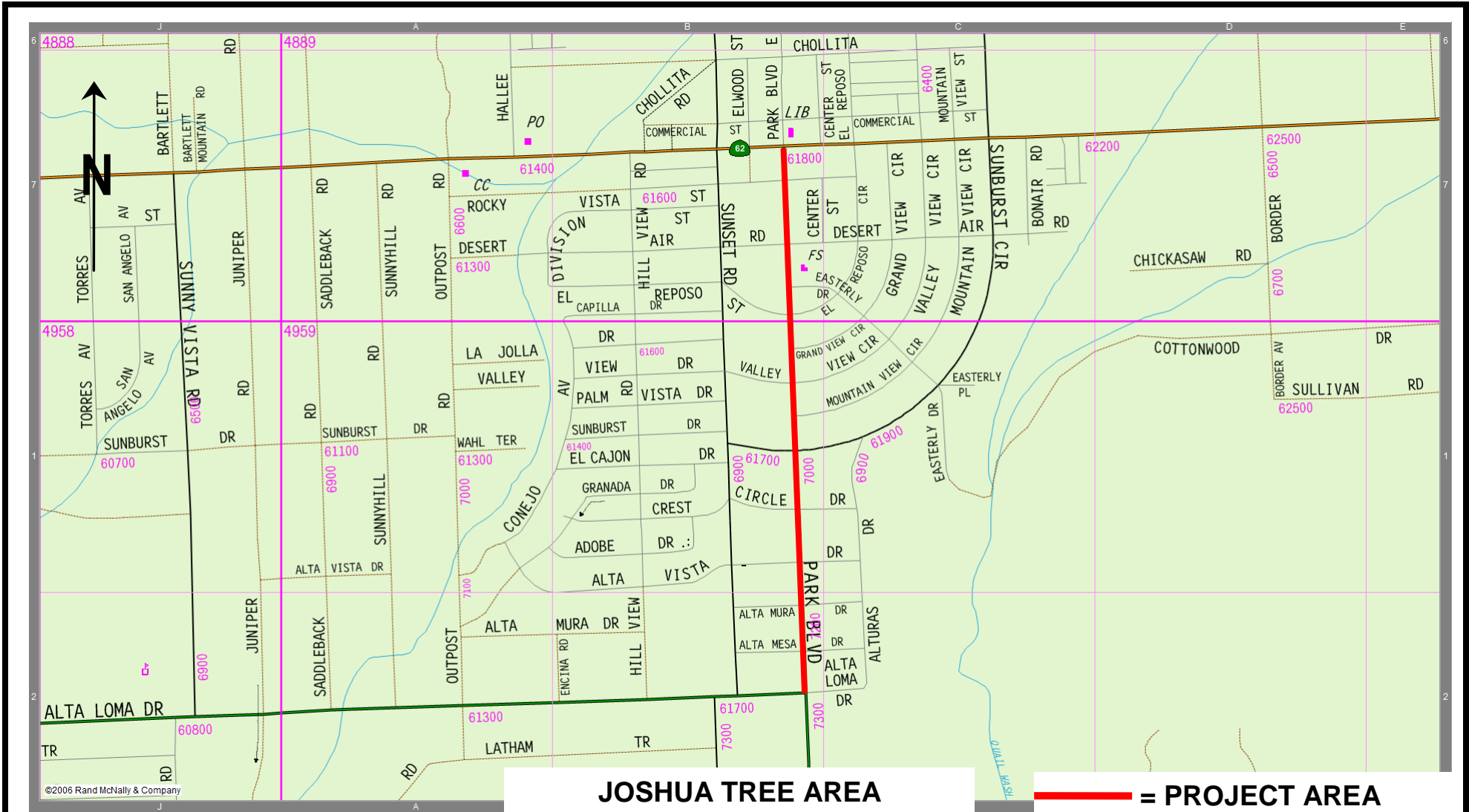

# LOCATION MAP

County Road # 640450 010

Work Order # H14844



COUNTY OF SAN BERNARDINO  
DEPARTMENT OF PUBLIC WORKS

**PARK BOULEVARD**  
*Alta Loma Drive to Twentynine Palms Highway (State Highway 62)*  
**ROADWAY RECONSTRUCTION**

Latitude: 34.1239 Longitude:- 116.3151